

A-OIL-SFT

Threading | Cutting taps | Metric

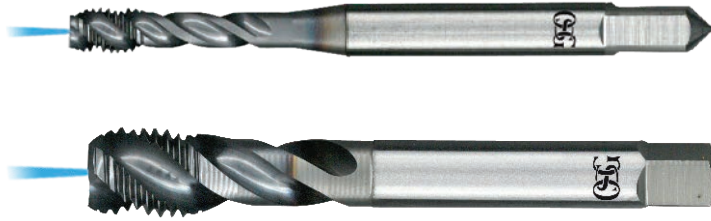

Type 1

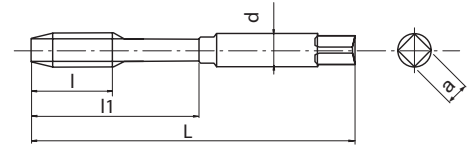

Type 2

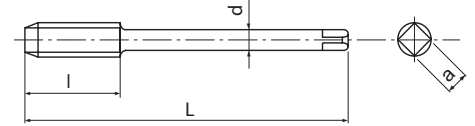

- First choice in quality and performance
- Powder metal spiral-fluted cutting tap for blind holes
- Multilayer TiCN coating
- High speed tapping in general steels, aluminium, stainless steels
- Centre through coolant

P	P	P	P	M	N	N	S	H	
C < 0,2%	0,25 < C < 0,4	C > 0,45%	SCM	INOX	Al	AC,ADC	Ti	25-35 HRC	
15-60	15-60	10-60	8-30	8-20	15-35	15-35	5-10	8-20	m/min

A	M	PM	V	45°	ISO 2 6HX	C/2,5			DIN 371	DIN 376
----------	----------	-----------	----------	------------	------------------	--------------	--	--	----------------	----------------

EDP	M	P	L	l	l1	d	a	Z	Type	DIN	Price
48140155	6	1	80	8	30	6	4,9	3	1	DIN371	
48140161	8	1,25	90	10	35	8	6,2	3	1	DIN371	
48140169	10	1,5	100	12	39	10	8	3	1	DIN371	
48140179	12	1,75	110	14	-	9	7	3	2	DIN376	
48140191	14	2	110	16	-	11	9	3	2	DIN376	
48140202	16	2	110	16	-	12	9	3	2	DIN376	
48140214	18	2,5	125	25	-	14	11	4	2	DIN376	
48140228	20	2,5	140	25	-	16	12	4	2	DIN376	
48140238	22	2,5	140	25	-	18	14,5	4	2	DIN376	
48140247	24	3	160	30	-	18	14,5	4	2	DIN376	
48140262	27	3	160	36	-	20	16	4	2	DIN376	
48140271	30	3,5	180	42	-	22	18	4	2	DIN376	
48140281	33	3,5	180	42	-	25	20	4	2	DIN376	
48140294	36	4	200	48	-	28	22	4	2	DIN376	
48140304	39	4	200	48	-	32	24	4	2	DIN376	
48140314	42	4,5	200	54	-	32	24	4	2	DIN376	
48140319	45	4,5	220	54	-	36	29	4	2	DIN376	
48140325	48	5	250	60	-	36	29	4	2	DIN376	
48140337	52	5	250	60	-	40	32	4	2	DIN376	
48140347	56	5,5	250	66	-	40	32	4	2	DIN376	

Threading | Cutting taps

Metric

A-OIL-POT

Threading | Cutting taps | Metric

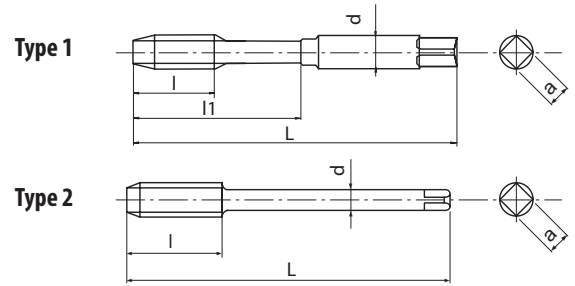

- First choice in quality and performance
- Powder metal spiral-point cutting tap for through holes
- Multilayer TiCN coating
- High speed tapping in general steels, aluminium, stainless steels
- Side through coolant

P C < 0,2%	P 0,25 < C < 0,4	P C > 0,45%	P SCM	M INOX	N Al	N AC,ADC	S Ti	H 25-35 HRC		m/min
15-60	15-60	10-60	8-30	8-20	15-35	15-35	5-10	8-20		



EDP	M	P	L	l	l1	d	a	Z	Type	DIN	Price
48214155	6	1	80	19	30	6	4,9	3	1	DIN371	
48214161	8	1,25	90	22	35	8	6,2	3	1	DIN371	
48214169	10	1,5	100	24	39	10	8	3	1	DIN371	
48214179	12	1,75	110	28	-	9	7	3	2	DIN376	
48214191	14	2	110	30	-	11	9	3	2	DIN376	
48214202	16	2	110	32	-	12	9	3	2	DIN376	
48214214	18	2,5	125	34	-	14	11	3	2	DIN376	
48214228	20	2,5	140	34	-	16	12	3	2	DIN376	
48214238	22	2,5	140	34	-	18	14,5	3	2	DIN376	
48214247	24	3	160	38	-	18	14,5	3	2	DIN376	

A-OIL-XP

Threading | Forming taps | Metric

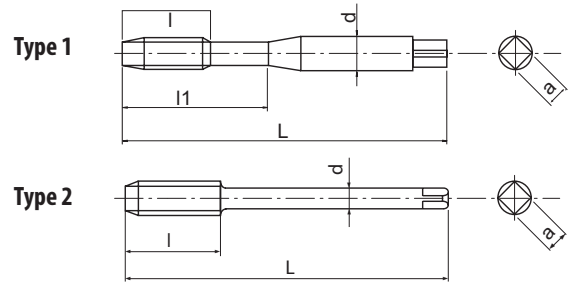

- First choice in quality and performance
- Powder metal forming tap for through & blind holes
- Multilayer TiCN coating
- High speed tapping in general steels, aluminium, stainless steels
- Side through coolant

P C < 0,2%	P 0,25 < C < 0,4	P C > 0,45%	P SCM	M INOX	N Al	N AC, ADC	H 25-35 HRC	m/min
15-40	15-40	15-30	15-30	8-20	20-50	20-40	5-20	

A	M	PM	V	ISO 2 6HX	C/2,5					DIN 2174	DIN 2174
----------	----------	-----------	----------	------------------	--------------	--	--	--	--	-----------------	-----------------

EDP	M	P	L	l	l1	d	a	Z	∅	Type	DIN
48225149	5	0,8	70	-	25	6	4,9	5	4,62 ~ 4,68	1	DIN2174
48225155	6	1	80	-	30	6	4,9	5	5,51 ~ 5,59	1	DIN2174
48225161	8	1,25	90	-	35	8	6,2	5	7,37 ~ 7,45	1	DIN2174
48225169	10	1,5	100	-	39	10	8	8	9,24 ~ 9,33	1	DIN2174
48225179	12	1,75	110	17	-	9	7	8	11,10 ~ 11,20	2	DIN2174
48225191	14	2	110	20	-	11	9	8	12,96 ~ 13,08	2	DIN2174
48225202	16	2	110	20	-	12	9	8	14,96 ~ 15,08	2	DIN2174
48225214	18	2,5	125	20	-	14	11	8	16,66 ~ 16,81	2	DIN2174
48225228	20	2,5	140	20	-	16	12	8	18,66 ~ 18,81	2	DIN2174
48225238	22	2,5	140	20	-	18	14,5	8	20,66 ~ 20,81	2	DIN2174
48225247	24	3	160	24	-	18	14,5	8	22,39 ~ 22,56	2	DIN2174
48225262	27	3	160	18	-	20	16	8	25,39 ~ 25,56	2	DIN2174
48225271	30	3,5	180	21	-	22	18	8	28,09 ~ 28,28	2	DIN2174
48225281	33	3,5	180	21	-	25	20	8	31,09 ~ 31,28	2	DIN2174
48225294	36	4	200	32	-	28	22	8	33,80 ~ 34,01	2	DIN2174
48225304	39	4	200	32	-	32	24	9	36,80 ~ 37,01	2	DIN2174
48225314	42	4,5	200	36	-	32	24	9	39,52 ~ 39,73	2	DIN2174
48225319	45	4,5	220	36	-	36	29	9	42,52 ~ 42,73	2	DIN2174

